

DIFFERENTIAL PRESSURE SWITCH NEMA 4, 4X, IP66

DPS2200W

Protection: IP66
Proof Pressure to 750psi
Adjustable Ranges: 400~10000 mmH₂O
Temperature: -30 to 205°C

The New-Flow DPS2200W, a water proof differential pressure switch, is designed to be used in control systems. DPS2200W has high set point repeatability and narrow dead band features. There is a variety of range selections available upon request. Easily adjusted to the set point, no special tools needed!

Technical Data

- Switch Data:** one SPDT & two SPDT Microswitch, 15amps 125/250VAC, DC 125V 0.4A, DC 30V 3A, / Gold Contact Microswitch 1A 125/250VAC
- Housing:** die cast aluminum alloy with paint
- Conduit Connection:** Female ¾", ½"NPT, M20 x P1.5 available
- Pressure Element:** welded type diaphragm
- Process Materials:** wetted parts are all in SS316+Titanium
- Process Connection:** with adaptor ½" or ¼" NPT, BSP and PT Female; and M20 x P1.5 thread available



Patent No.
M450724
China: 2976852

Approvals:

ABS
TYPE APPROVED PRODUCT

CE

EAC

UL Switches with UL & CSA Recognized and File No. E12252.

Dimensions

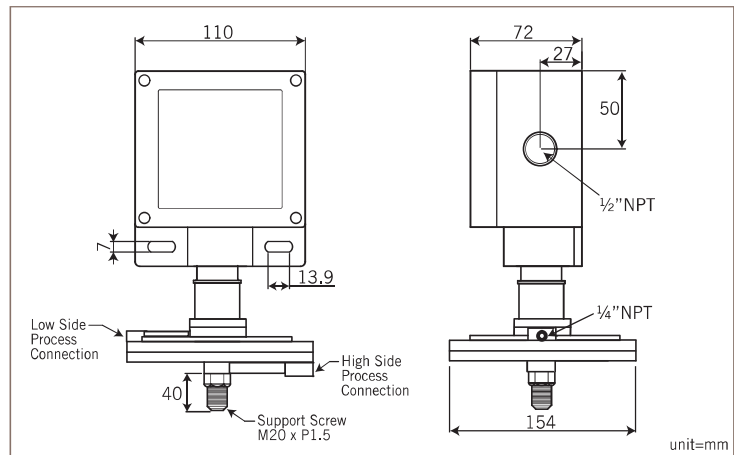

Range Selection Table

Code	Adjustable Range	Dead Band	Maximum Pressure Proof
10R	400~1900 mmH ₂ O	30~80 mmH ₂ O	750 psi
20R	1000~10000 mmH ₂ O	70~200 mmH ₂ O	750 psi

Ordering Information

DPS2200W	Code	Range															
		10R	400~1900 mmH ₂ O	20R	1000~10000 mmH ₂ O												
		Code	Wetted Parts Material														
		A	SS316+Titanium														
		Code	Process Connection (with adaptor)– Female														
			(1) ½"NPT (2) ¼"NPT (3) ½"BSP (4) ¼"BSP (5) ½"PT (6) ¼"PT (7) M20 x P1.5														
		Code	Conduit Connection														
			(E) ¾"NPT Female (F) ½"NPT Female, standard (G) M20 x P1.5 Female														
		Code	Switch Form														
		1	Micro Switch, 1 SPDT														
	2	Micro Switch, 2 SPDT (one setting point)															
	3a	Gold Contact, 1 SPDT															
	3b	Gold Contact, 2 SPDT (one setting point)															
<table border="1" style="width:100%; border-collapse: collapse;"> <tr> <td style="width:15%;">DPS2200W</td> <td style="width:10%;"></td> <td style="width:10%;"></td> <td style="width:10%;"></td> <td style="width:10%;"></td> <td style="width:10%;"></td> <td style="width:10%;"></td> <td style="width:10%;"></td> <td style="width:10%;"></td> </tr> </table>									DPS2200W								
DPS2200W																	

Complete Ordering Code